

## Rail Crossing



## Sidewalks

Pedestrian sidewalks with new railing will be provided on the bridge crossings of Chilliwack Creek and the Diversion.



## Bridge over the Trans Canada Highway

Center pier between the east and westbound lanes of the Trans Canada Highway are necessary to support the Evans Crossing.



## Project Partners



## More Information:

This project will result in long term changes to commuting and traffic patterns. A simplified route plan and other information are posted on the City website at [www.chilliwack.com/evans](http://www.chilliwack.com/evans) and will be updated regularly. If you still have questions about the project, please contact the Engineering Department at City Hall at 604-793-2907.

# Evans Interchange/Connector Project



Retaining walls redefine Luckakuck Way

# Summer 2009!

- Project Update -



## Retaining Wall Construction



Retaining wall construction utilizing the reinforced earth method.

## Proposed Roundabout at Evans/Yale Intersection

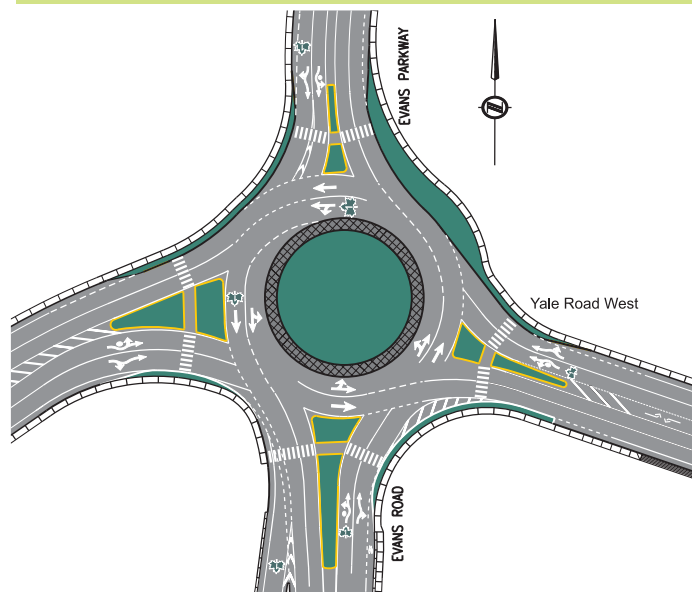

## Bridge Construction Over Trans Canada Highway



Concrete placement for bridge abutments on the south side of the Trans Canada Highway. Bridge girder placement is planned for summer 2009.

## Luckakuck Way Re-opened

Luckakuck Way re-opened for east-west thru traffic on Friday, May 15, 2009. The north end of Evans Road will remain closed until July 2 (see right). Thank you to all residents, businesses and patrons for your patience during this phase of construction.

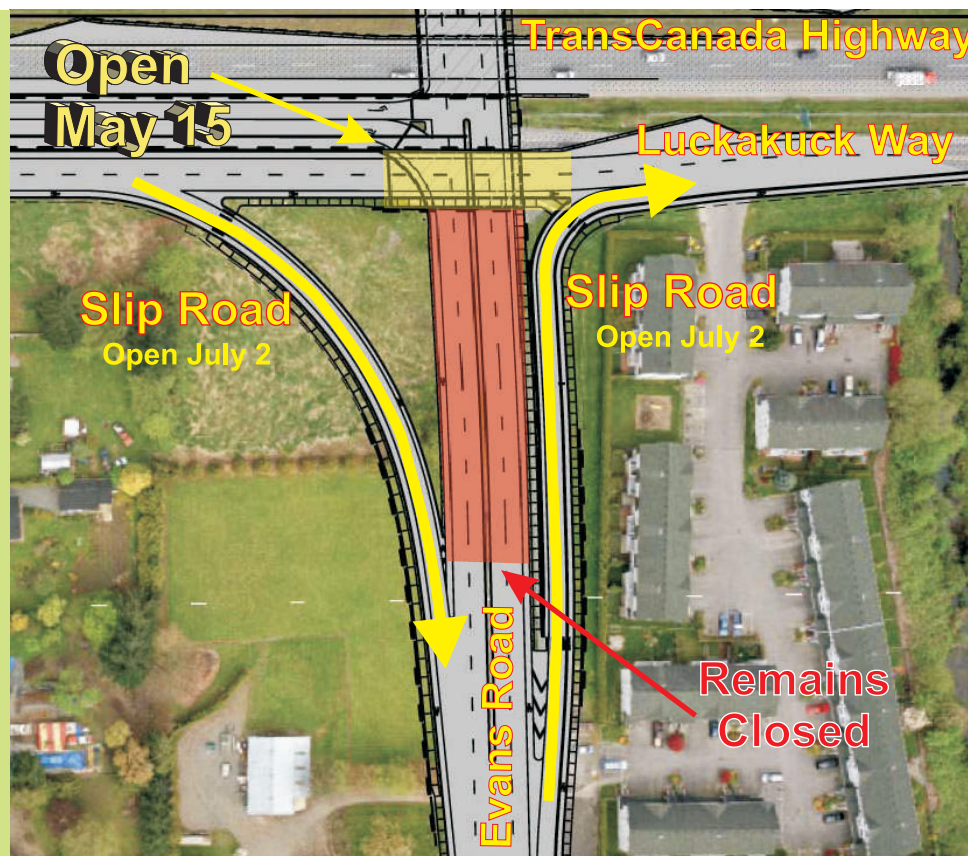

## Evans Slip Roads Open

Martens Asphalt plans to open the Evans slip roads (illustrated on left) on July 2. These slip roads will provide limited movement between Luckakuck Way and Evans Road. As part of the slip road opening, the traffic signal at Evans Road and Knight Road intersection will be activated. To facilitate the opening, the 4 lane road marking will be applied to Evans Road from Luckakuck south to the Southern Rail crossing. This 4 lane conversion will require parking prohibition on both the east and west sides of Evans Road.